

## PREFABRİK ŞANTIYE BİNALARI

### Kullanılan Malzeme Özellikleri

Standart üretimlerde kar yükü 80 kg<sup>2</sup>, rüzgar yükü 102 km/h dir. Yapı yükseklikleri ihtiyaca göre 2500-2800-3000 mm olup tek katlı veya çift katlı olarak üretimi yapılmaktadır. Yapılar 1020 mm veya 1250 mm nin katları ile istenilen uzunluk ve genişlikte her türlü yerleşim planına uyarlanabilen, defalarca montaj ve demontaj özelliğine sahip yapılardır. Çatı makasları roll-form makinelerinde kaynaksız olarak özel şekillendirilmiş profillerden veya kutu profillerden oluşmaktadır. Çatı kaplamasında galvanizli trapez sac, boyalı sac, sandviç panel ve shingle uygulaması yapılmaktadır. Birleşim ve kapatma elemanları galvanizli sacdan özel şekillendirilmiş profillerden oluşur. Elektrostatik toz boyalıdır. İç ve dış duvarlarda 60 mm ve 100 mm eps dolgulu her iki yüzeyi ral 9002 renginde elektrostatik toz boyalı, hadveli galvaniz sac veya çimentolu yonga levha olan sandviç paneller kullanılır. Pencereler TSE belgeli sert plastik, çelik takviyeli beyaz pvc doğramalardır, 4+12+4 mm çift cam kullanılmaktadır. Dış kapılar 2 mm bükme sac profil kasalı, 1 mm kalınlıkta kanatlı, her iki yüzü elektrostatik fırın boyalı özel şekillendirilmiş sacdan üretilmiş ve camyünü yalıtımlı çelik kanatlı kapılardır. Rüzgar, toz ve sese karşı contalıdır. İç kapılar ahşap serenlerin birleştirilmesiyle oluşan, içi kağıt petek dolgulu amerikan panel ahşap pres kapılardır. TSE belgeli vitrikiye malzemesi ve armatürleri, elektrik ve sıhhi tesisatı döşenmiş olarak teslim edilir.

### Kullanım Alanları

İşçi Yatakhaneleri, Ofis Binaları, Mühendis Yatakhaneleri, Yemekhane ve Lokal Binaları, Askeri Yapılar, Hizmet Binaları ve İdari Binalar, Wc-Duş Binaları



## PREFABRICATED SITE FACILITIES

### Direct Material Properties

*In standard production snow load is 80 kg<sup>2</sup>, wind load is 102 km/h. The building heights are 2500-2800-3000 mm, and it can be produced as single layer or double layer according to need. The buildings can be adapted to any layout with desired length and width with multiples of 1020 mm or 1250 mm and they have the feature of installation and removal procedure. The roof trusses consist of specially shaped profiles without welding in roll-form machines or box profiles. Galvanized trapezoidal sheet (deck sheet) metal, painted sheet, sandwich panel and shingle are applied in the roof covering. The joining and closing elements consist of specially formed profiles from galvanized sheet. Electrostatics' feature is powder coated. Sandwich panels, which are 60 mm and 100 mm eps filled, electrostatic powder coated, galvanized steel pitch sheet or cemented flakeboard are used for inner and outer wall. Windows are steel reinforced hard plastic white pvc joinery that has TSE certified and double glass with 4 + 12 + 4 mm. Exterior doors are made of 2 mm bending sheet metal frame, 1 mm thick wing, both sides of electrostatic oven painted special shaped sheet and glass wool insulated steel wing doors. They are sealed against wind, dust and noise. Interior doors are American panel wooden press doors that are wooden honeycomb filling formed by combining wooden spines. They are delivered as furnished with TSE certified vitrified material and fittings, electrical and sanitary installations.*

### Usage Areas

*Workers Dormitories, Office Buildings, Engineer Dormitories, Dining Hall and Local Buildings, Military Buildings, Service Buildings and Administrative Buildings, WC-Shower Buildings*

## KONTEYNER YAPILAR

### Kullanılan Malzeme Özellikleri

Müşterilerin yurtiçi ve yurtdışı şantiyelerindeki ihtiyaçları için, demonte ya da montajlı olarak, kurulacağı yerin kar yükü, rüzgar yükü, iklim şartları ve konteynerin ölçüleri dikkate alınarak imalat yapılmaktadır. Taşıyıcı sistemin malzeme kalınlıkları bu hesaplara göre belirlenmektedir. İç ve dış duvarlarda 60 mm eps dolgulu her iki yüzeyi ral 9002 renginde elektrostatik toz boyalı, hadveli galvaniz sac sandviç panel kullanılır. Dış kapılar 2 mm bükme sac profil kasalı, 1 mm kalınlıkta kanatlı, her iki yüzü elektrostatik fırın boyalı özel şekillendirilmiş sacdan üretilmiş ve camyünü yalıtımlı çelik kanatlı kapılardır. Rüzgar, toz ve sese karşı contalıdır. İç kapılar ahşap serenlerin birleştirilmesiyle oluşan, iç kağıt petek dolgulu amerikan panel ahşap pres kapılardır. Pencereler TSE belgeli sert plastik, çelik takviyeli beyaz pvc doğramalardır, 4+12+4 mm çift cam kullanılmaktadır. TSE belgeli vitrifiye malzemesi ve armatürleri, elektrik ve sıhhi tesisatı döşenmiş olarak teslim edilir. Modüler yan yana birleşik olarak veya üst üste konularak da kullanılabilir.

### Kullanım Alanları

İşçi Yatakhaneleri, Ofisler, Mühendis Yatakhaneleri, Yemekhaneler, Kumanda Kabinleri, Güvenlik Kabinleri, Wc-Duş Üniteleri

## CONTAINER BUILDINGS

### Direct Material Properties

Manufacturing is done considering the disassembled or assembled features, snow load, wind load, climatic conditions and container dimensions for the needs in customers' local and international construction sites. Material thicknesses of the carrier system is determined according to these calculations. Galvanized steel pitch sheet sandwich panels which are 60 mm and 100 mm eps filled and coated with electrostatic powder painted in ral 9002 color on both surfaces are used for inner and outer wall. Exterior doors are made of 2 mm bending sheet metal frame, 1 mm thick wing, both sides of electrostatic oven painted special shaped sheet and glass wool insulated steel wing doors. They are sealed against wind, dust and noise. Interior doors are American panel wooden press doors that are wooden honeycomb filling formed by combining wooden spines. Windows are steel reinforced hard plastic white pvc joinery that has TSE certified and double glass with 4 + 12 + 4 mm. They are delivered as furnished with TSE certified vitrified material and fittings, electrical and sanitary installations. They can also be used modularly, side by side or by overlapping.

### Usage Areas

Workers Dormitories, Office Buildings, Engineer Dormitories, Dining Halls, Control Cabinets, Security Cabinets and WC-Shower Units





## ÇELİK YAPILAR

### Kullanılan Malzeme Özellikleri

NPI putrel kolon ve kiriş, köşebent rüzgar çaprazları özel şekillendirilmiş galvanizli profil veya kutu profil aşıklardan oluşur. Birleşimleri tamamen çelik civata ve somun ile yapılmaktadır. Yapının defalarca sökülüp tekrar kurulmasına olanak sağlar. Cephe ve çatı kaplamalarında 0,50 mm 27/200 hadveli galvanizli trapez sac veya eps ve poliüretan dolgulu her iki yüzeyi ral 9002 renginde elektrostatik toz boyalı, hadveli galvaniz sac sandviç panel kullanılır. Hadvelerin birbirleri üzerine sabitlenmesi ve özel detaylar sayesinde sızdırmaz bir yüzey oluşmaktadır. Kaplama, özel contalı vidalar ile çelik aşıklara tesbit edilir. Yapıların yan cephe saçak altında cam elyaf takviyeli (CTP) şeffaf polyester aydınlatma levhaları kullanılarak gün ışığının %83'ü içeri vererek doğal aydınlatma sağlar. Standart üretimlerde kar yükü 80 kg<sup>2</sup>, rüzgar yükü 102 km/h dir. TS 498 ve TS 648 olmak üzere TSE, DIN, ASTM ve ISO standart ve normal tasarımlarımızda referans oluşturmaktadır.

### Kullanım Alanları

Atölye ve Depolar, Hangarlar, Üretim Tesisleri,  
Garajlar, Spor Tesisleri, Hayvan Barınakları

## STEEL STRUCTURES

### *Direct Material Properties*

*NPI putrel column and beam, gusset wind diameters are specially formed by galvanized profile or box profile. Joints are completely made of steel bolts and nuts. This feature allows the structure to be removed and reinstalled repeatedly. In facade and roof coverings, 0.50 mm 27/200 with galvanized trapezoidal sheet or eps and polyurethane filled, both surfaces coated by electrostatic powder colored by ral 9002 galvanized steel sheet sandwich panel is used. Thanks to the fixing of the ribs on each other and other special details, a sealed surface is formed. The coating is fixed to steel purlins with special seal screws. Glass fiber reinforced (GRP) transparent polyester illumination plates are used under the side facade of the buildings and this provides 83% of daylight and provides natural lighting. In standard production snow load is 80 kg<sup>2</sup>, wind load is 102 km/h. TS 498 ve TS 648 as well as TSE, DIN, ASTM ve ISO are the references of our standard and normal designs.*

### Usage Areas

*Workshops and Warehouses, Hangars, Production Facilities, Garages, Sports Facilities, Animal Shelters*



## PREFABRİK KONUTLAR

### Kullanılan Malzeme Özellikleri

Standart üretimlerde kar yükü 80 kg<sup>2</sup>, rüzgar yükü 102 km/h dir. Yapı yükseklikleri ihtiyaca göre 2500-2800-3000 mm olup tek katlı veya çift katlı olarak üretimi yapılmaktadır. Yapılar 1250 mm nin katları ile istenilen uzunluk ve genişlikte her türlü yerleşim planına uyarlanabilen, defalarca montaj ve demontaj özelliğine sahip yapılarıdır. Çatı makasları roll-form makinelerinde kaynak-sız olarak özel şekillendirilmiş profillerden veya kutu profillerden oluşmaktadır. Çatı kaplamasında galvanizli trapez sac, boyalı sac, sandviç panel ve shingle uygulaması yapılmaktadır. Cep-hede boya uygulaması , siding kaplama vb. malzemeler uygulanabilir. Birleşim ve kapatma elemanları galvanizli sacdan özel şekillendirilmiş profillerden oluşur. Elektrostatik toz boyalıdır. İç ve dış duvarlar 60 mm ve 100 mm eps dolgulu her iki yüzeyi çimentolu yonga levha olan sandviç paneller kullanılır. Pencere TSE belgeli sert plastik, çelik takviyeli beyaz pvc doğramalardır, 4+12+4 mm çift cam kullanılmaktadır. Dış kapılar 2 mm bükme sac profil kasalı, 1 mm kalınlıkta kanatlı, her iki yüzü elektrostatik fırın boyalı özel şekillendirilmiş sacdan üretilmiş ve camyünü yalıtımlı çelik kanatlı kapılardır. Rüzgar, toz ve sese karşı contalıdır. İç kapılar ahşap serenlerin birleştirilmesiyle oluşan, içi kağıt petek dolgulu amerikan panel ahşap pres kapılardır. TSE belgeli vitriye malzemesi ve armatürleri, elektrik ve sıhhi tesisatı döşenmiş olarak teslim edilir.

### Kullanım Alanları

Hobi Bahçeleri, Bağ Evleri, Köy Evleri, Afet Konutları, Askeri Lojmanlar, İşçi ve Personel Lojmanları

## PREFABRICATED RESIDENCES

### Direct Material Properties

*In standard production, snow load is 80 kg<sup>2</sup> and wind load is 102 km/h. The building heights are 2500-2800-3000 mm, and it can be produced as single layer or double layer according to need. The buildings can be adapted to any layout with desired length and width with multiples of 1020 mm or 1250 mm and they have the feature of installation and removal procedure. The roof trusses consist of specially shaped profiles without welding in roll-form machines or box profiles. Galvanized trapezoidal sheet (deck sheet) metal, painted sheet, sandwich panel and shingle are applied in the roof covering. As the application of facade paint, siding coating etc. can be applied. The joining and closing elements consist of specially formed profiles from galvanized sheet. Electrostatics' feature is powder coated. Sandwich panels, which are 60 mm and 100 mm eps filled, electrostatic powder coated, galvanized steel pitch sheet or cemented flakeboard are used for inner and outer wall. Windows are steel reinforced hard plastic white pvc joinery that has TSE certified and double glass with 4 + 12 + 4 mm is used. Exterior doors are made of 2 mm bending sheet metal frame, 1 mm thick wing, both sides of electrostatic oven painted special shaped sheet and glass wool insulated steel wing doors. They are sealed against wind, dust and noise. Interior doors are American panel wooden press doors that are wooden honeycomb filling formed by combining wooden spines. They are delivered as furnished with TSE certified vitrified material and fittings, electrical and sanitary installations.*

### Usage Areas

Urban Gardens, Hobby Gardens, Country Cottages, Village Houses, Disaster Housing, Military Housing, Worker and Staff Housing







## OFİS 190.66 m<sup>2</sup>

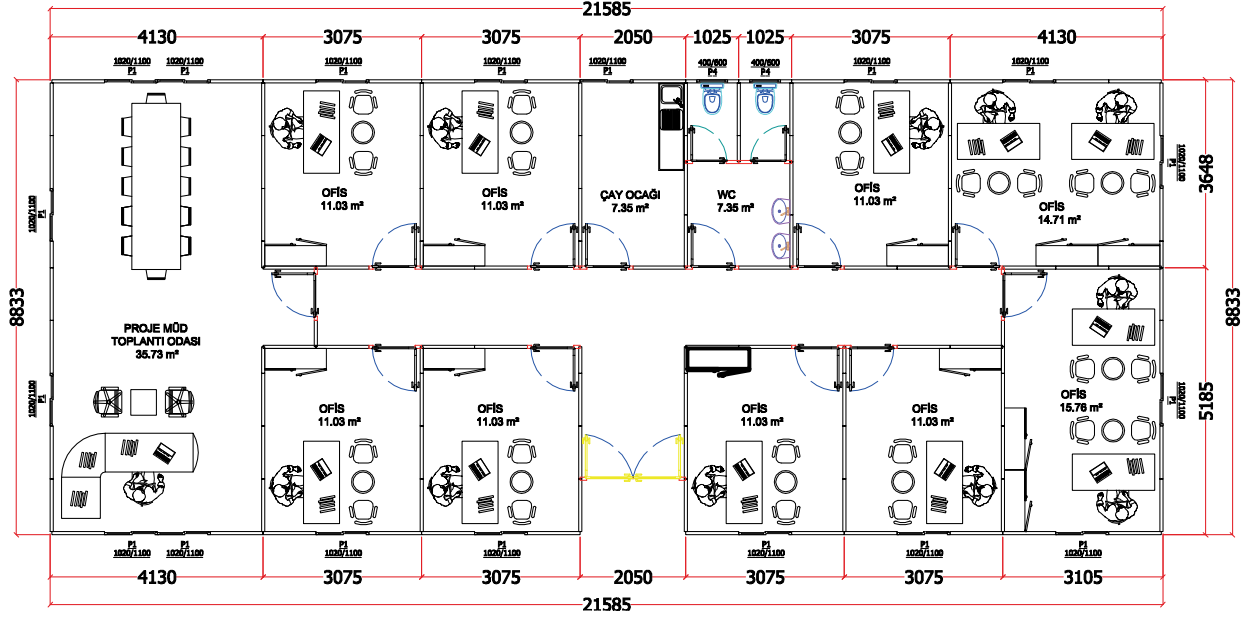

## OFİS 354.25 m<sup>2</sup>

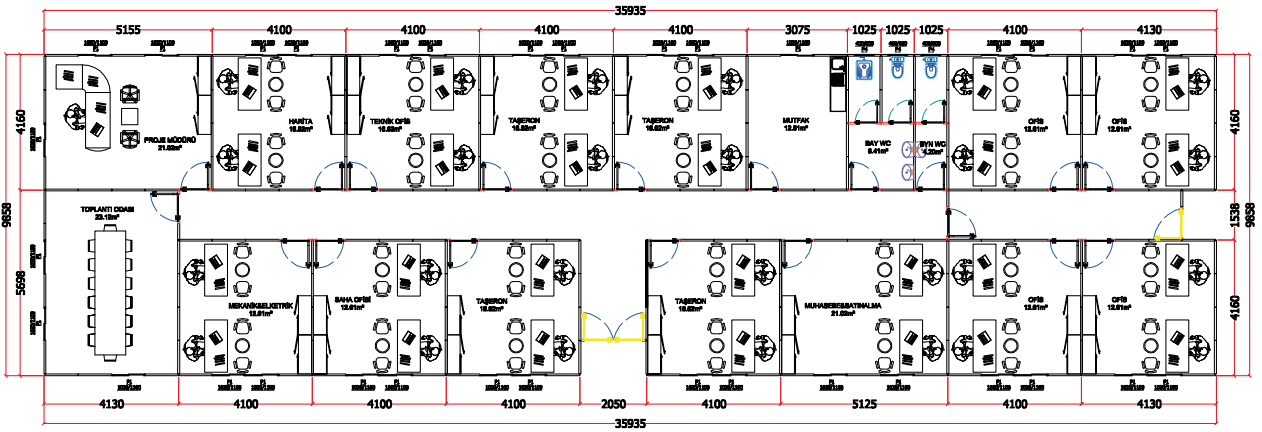



## İŞÇİ YTK 157.46 m<sup>2</sup>

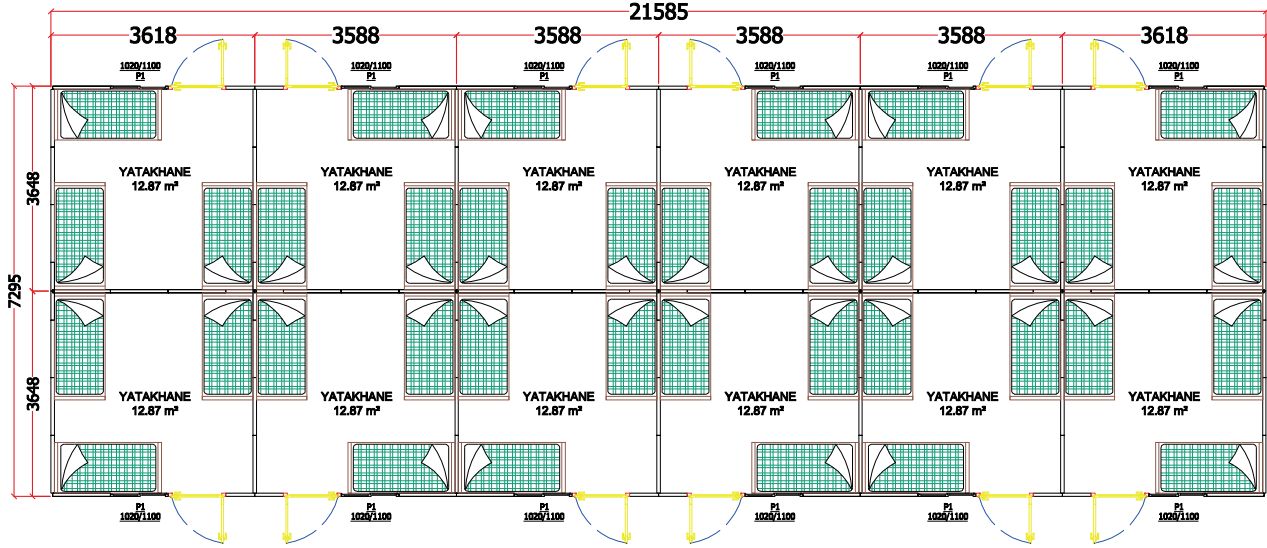

## İŞÇİ YTK 232.99 m<sup>2</sup>

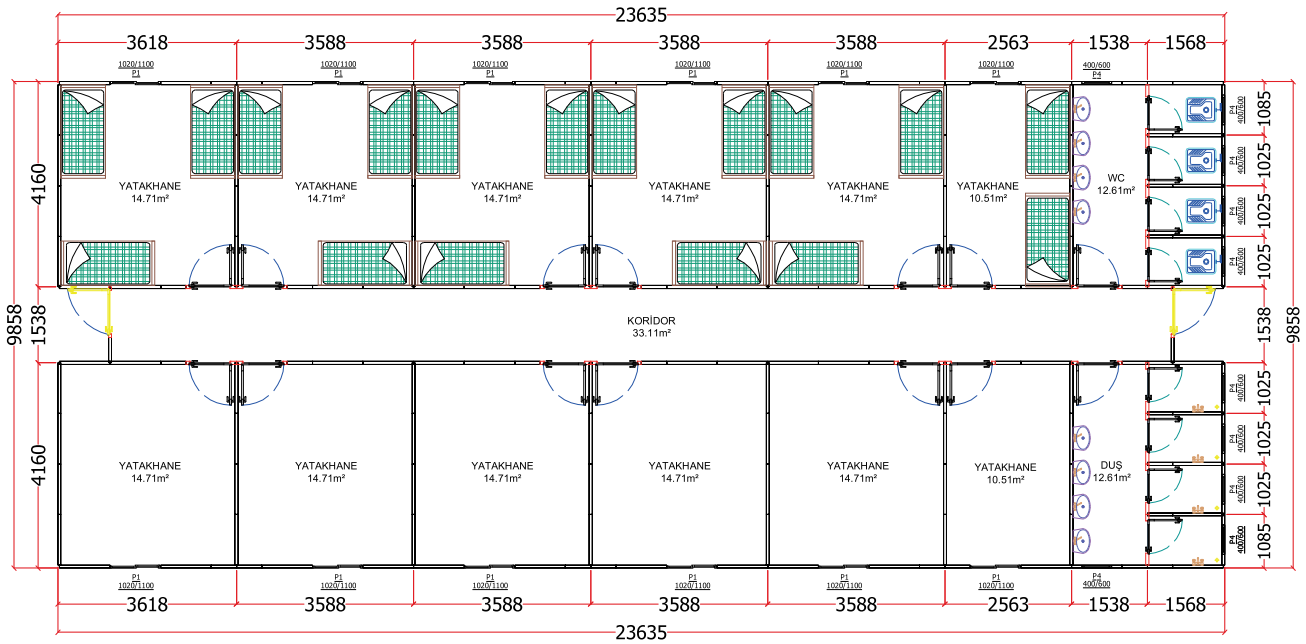

## İŞÇİ YTK 354.25 m<sup>2</sup>

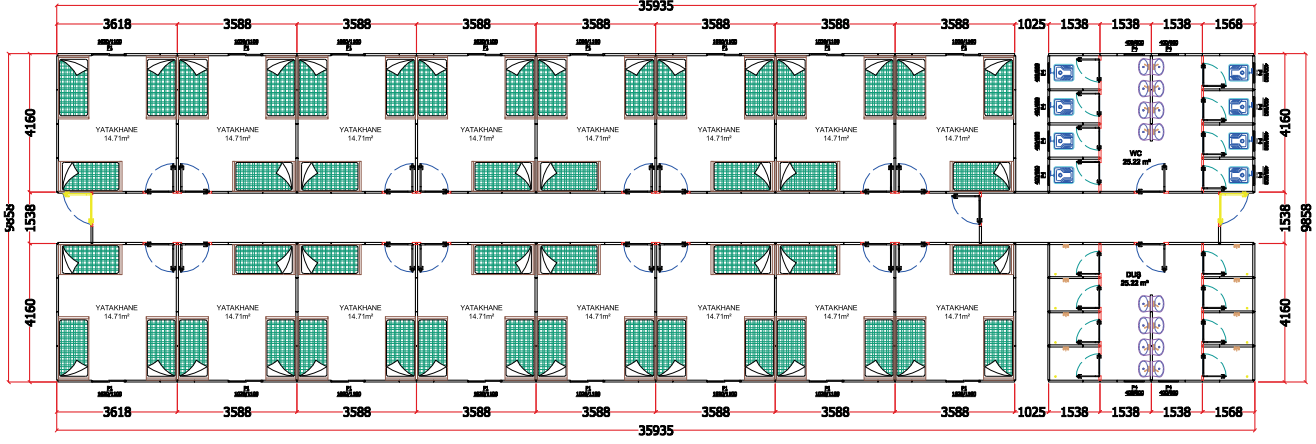

## İŞÇİ YTK 526.61 m<sup>2</sup>

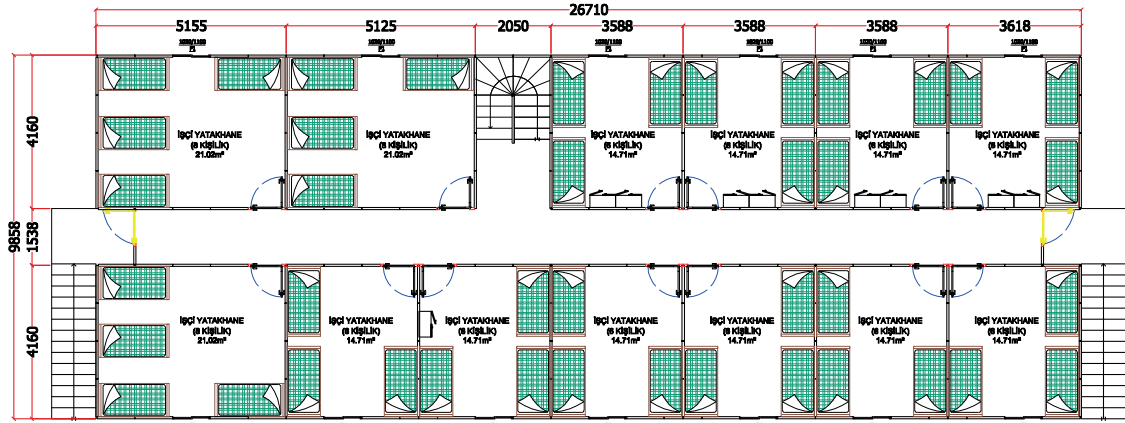

1.KAT PLANI

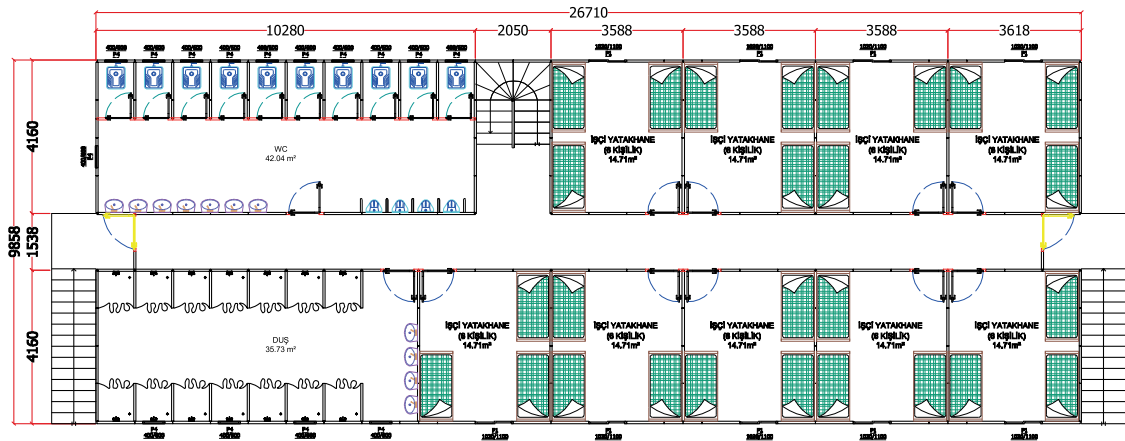

ZEMİN KAT PLANI



## MÜHENDİS YTK 162.26 m<sup>2</sup>

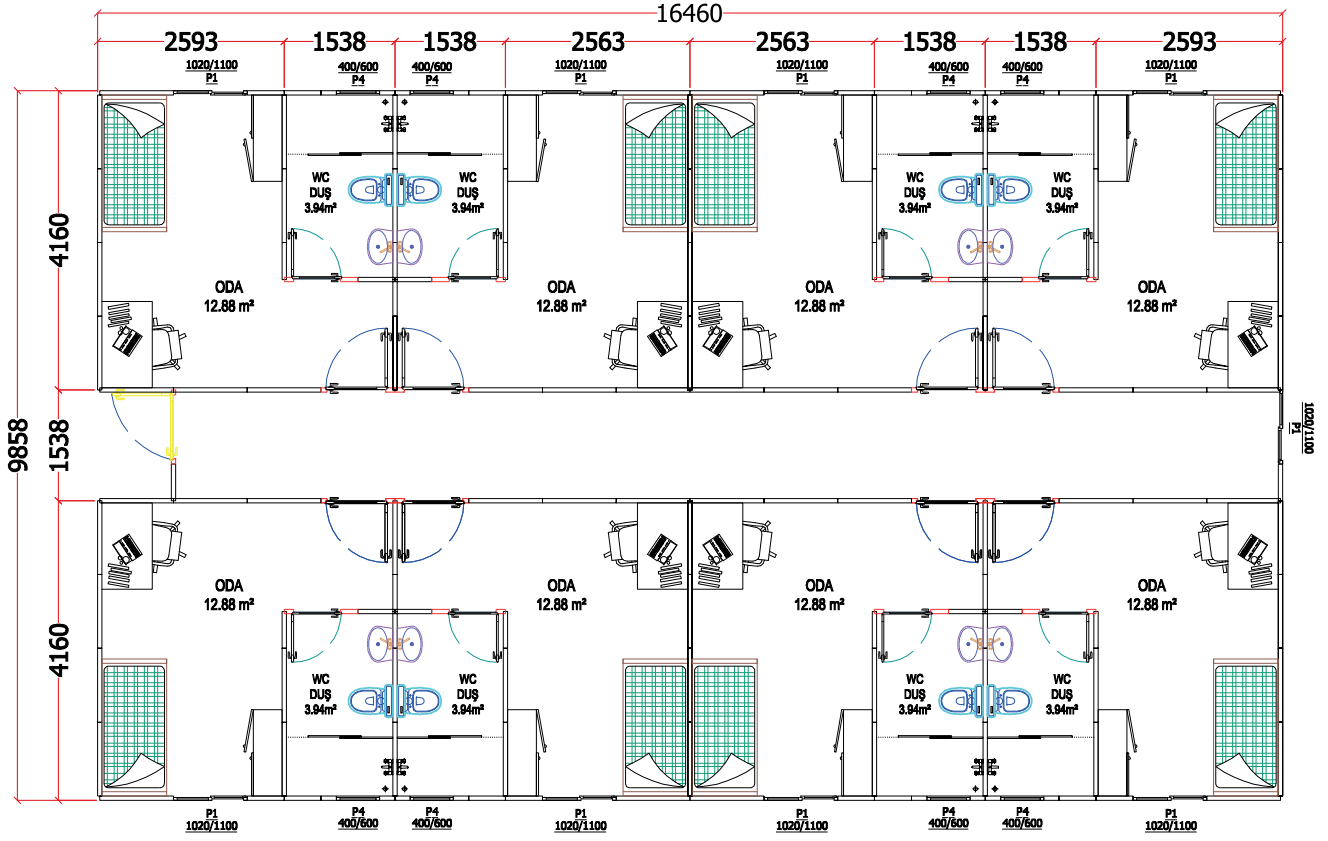

## MÜHENDİS YTK 199.71 m<sup>2</sup>

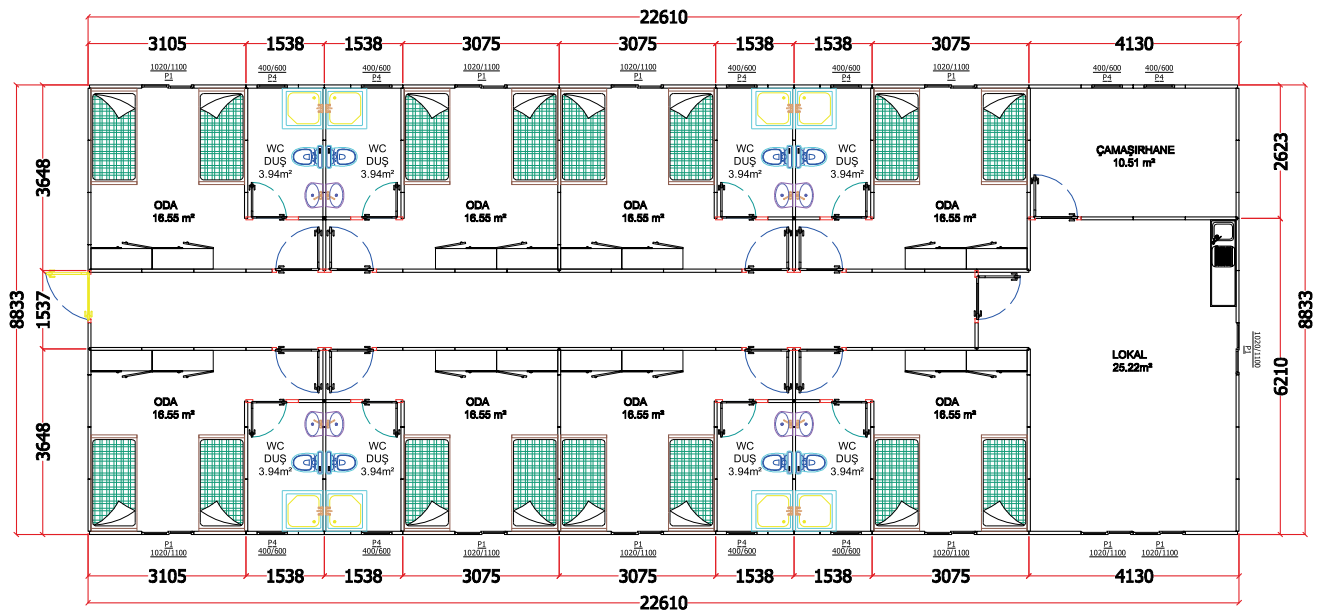





## YEMEKHANE

77.50 m<sup>2</sup>

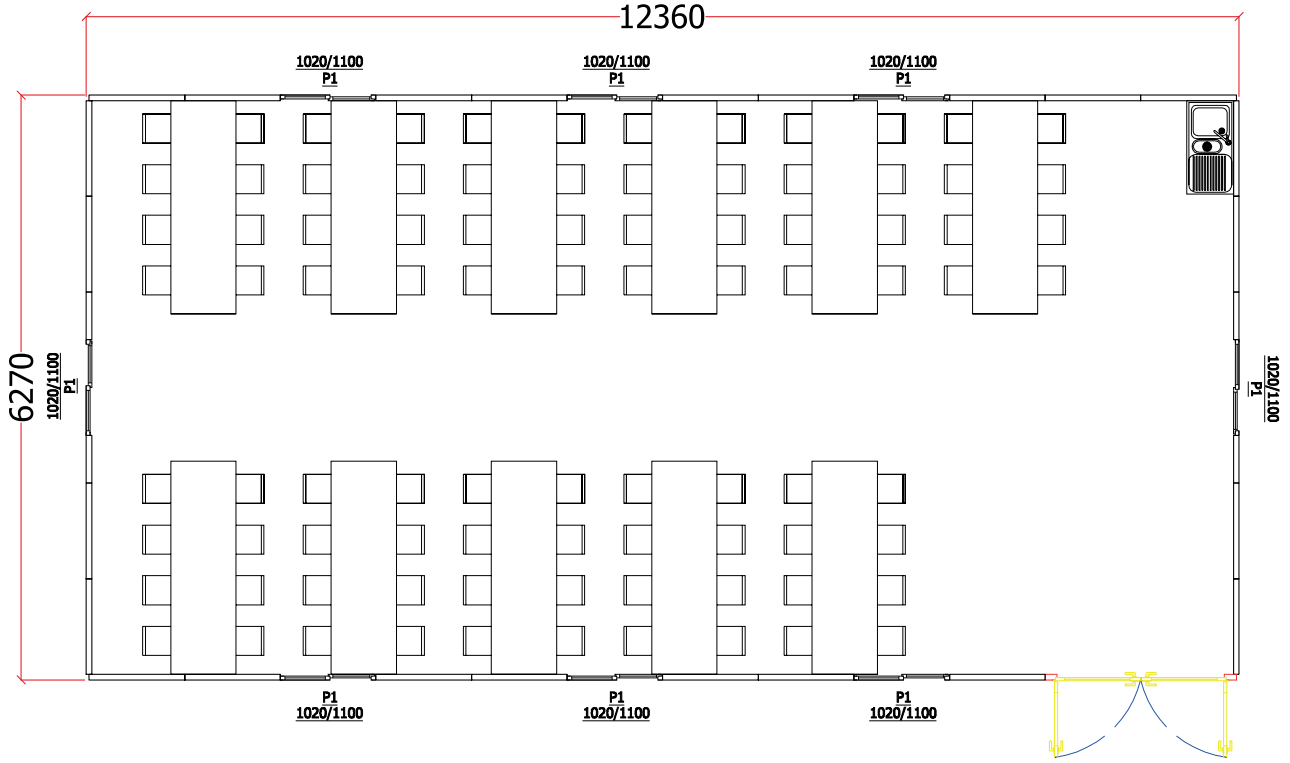

## YEMEKHANE

128.91 m<sup>2</sup>

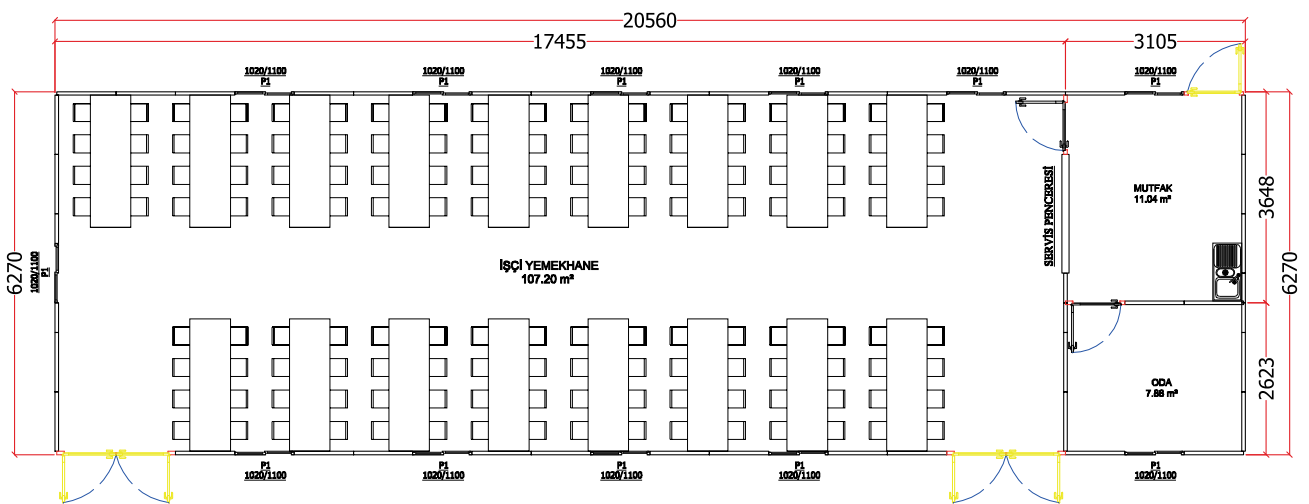

## YEMEKHANE

194.85 m<sup>2</sup>

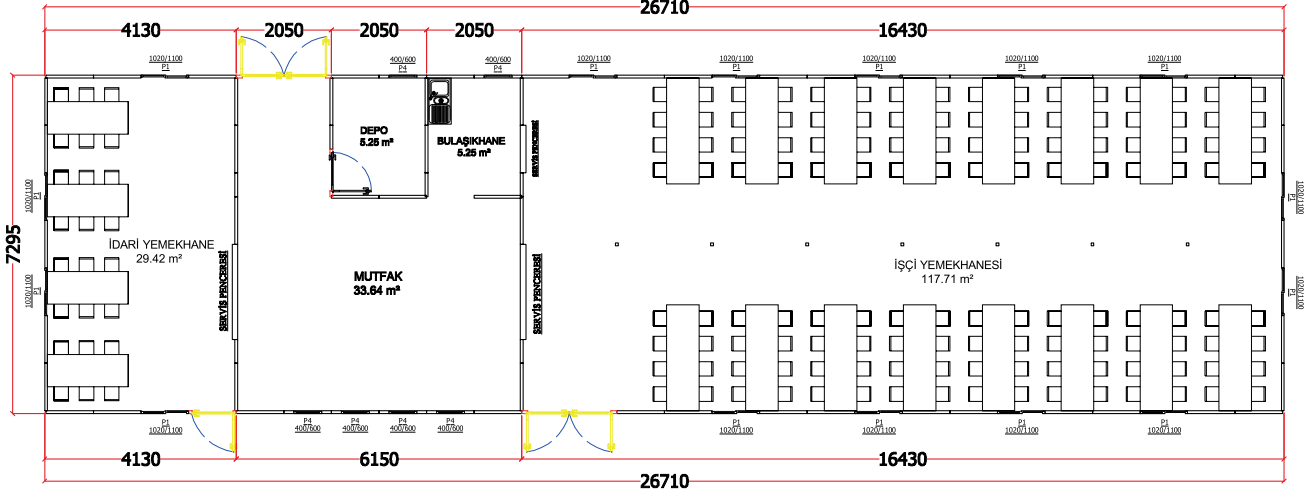

## YEMEKHANE

290.45 m<sup>2</sup>

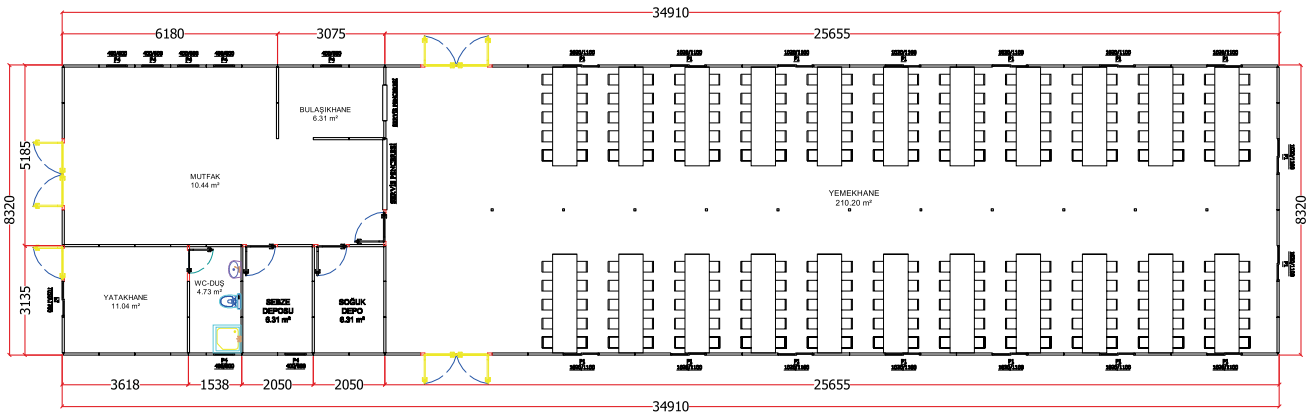





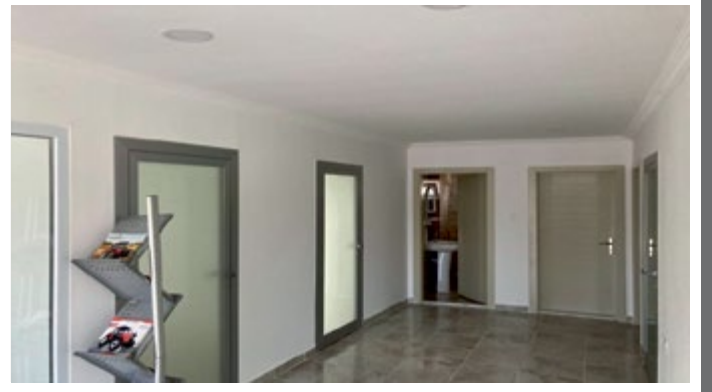

## ÇELİK DEPO BİNASI

163.98 m<sup>2</sup>

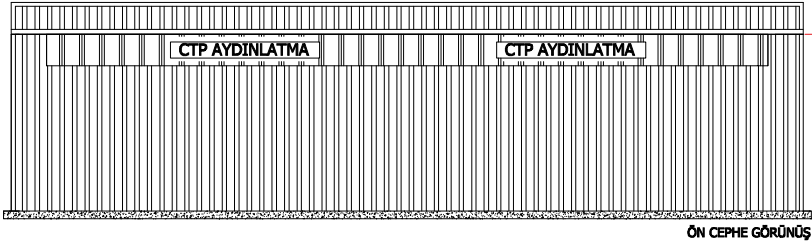
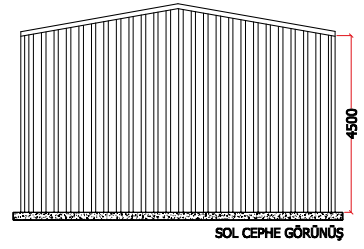
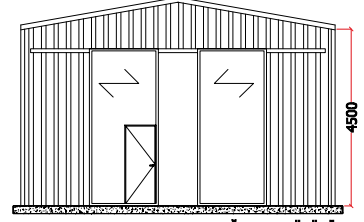
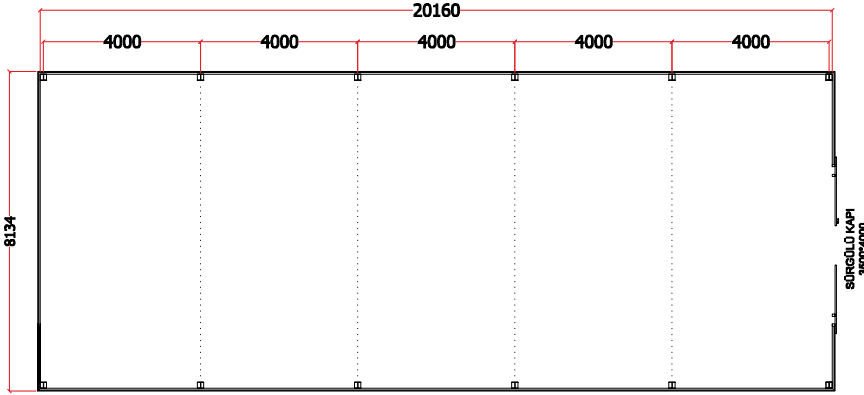

## ÇELİK DEPO BİNASI

325.26 m<sup>2</sup>

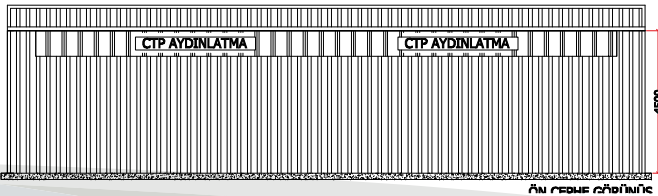
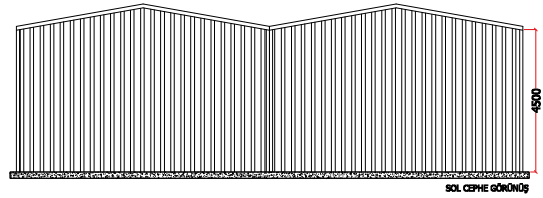
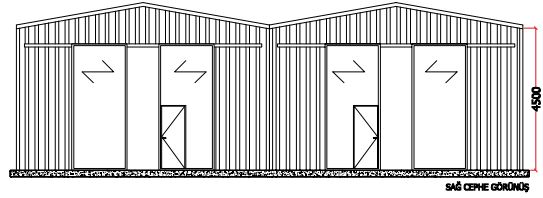
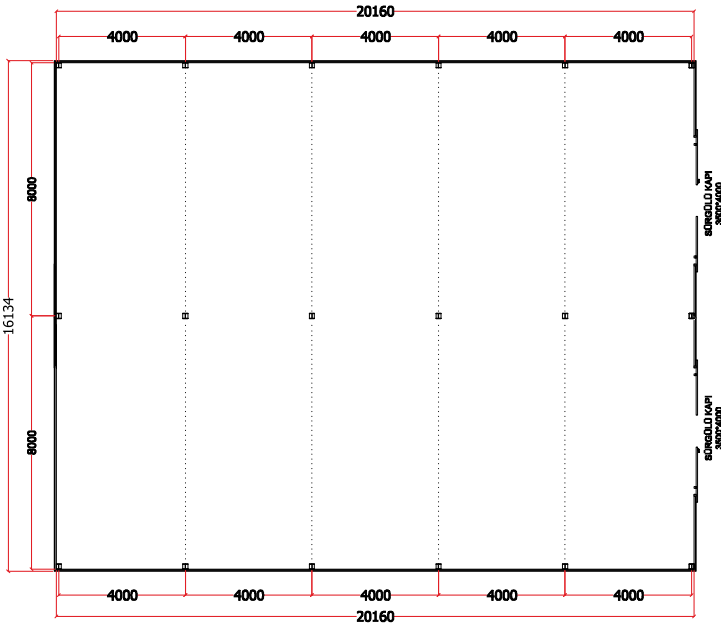







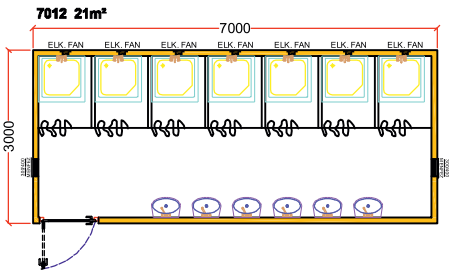
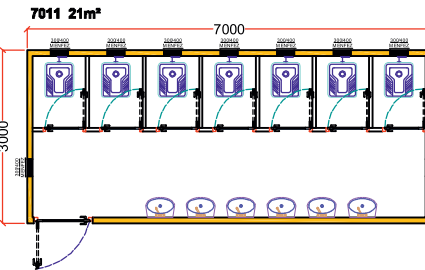
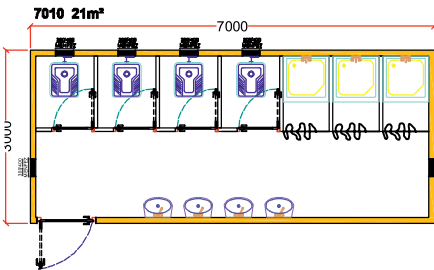
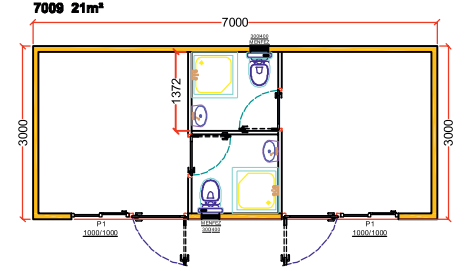
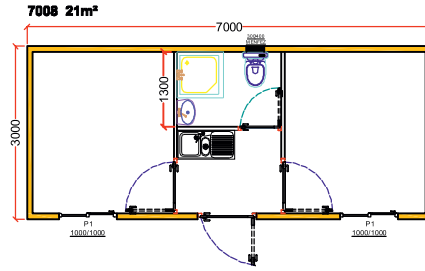
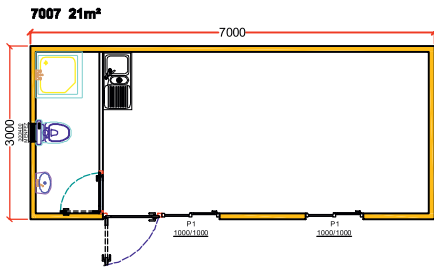
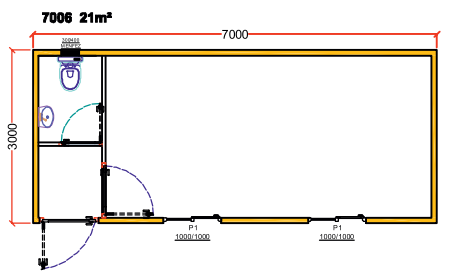
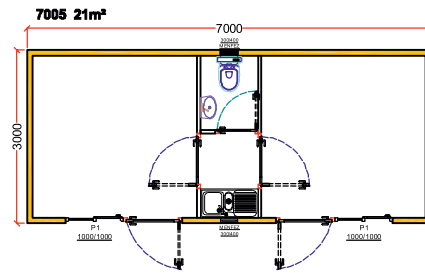
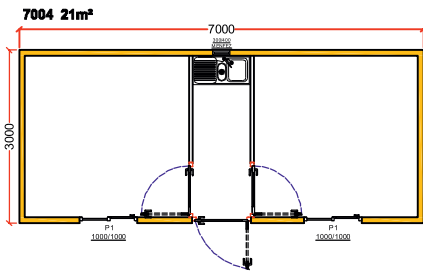
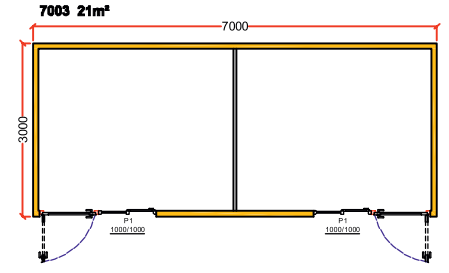
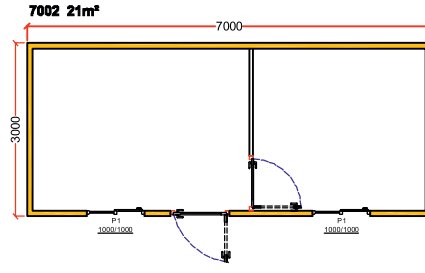
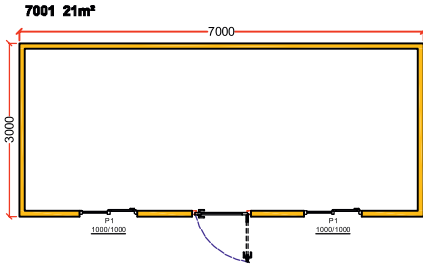

İSTENİLEN ÖLÇÜLERDE ÜRETİMLERİMİZ MEVCUTTUR.

## GÜVENLİK KABİNLERİ

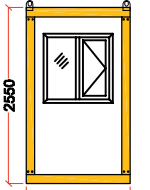

ÖN CEPHE GÖRÜNÜŞÜ

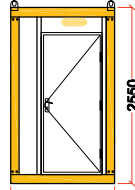

ARKA CEPHE GÖRÜNÜŞÜ

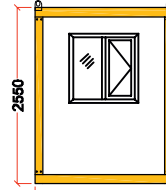

ÖN CEPHE GÖRÜNÜŞÜ

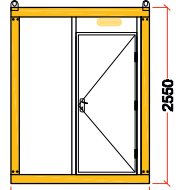

ARKA CEPHE GÖRÜNÜŞÜ

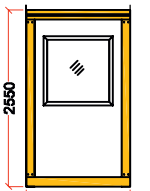
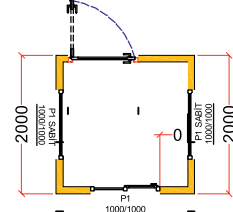
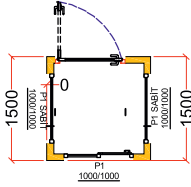

SOL CEPHE GÖRÜNÜŞÜ

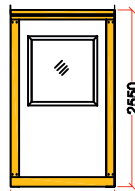

SAĞ CEPHE GÖRÜNÜŞÜ

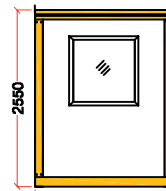

SOL CEPHE GÖRÜNÜŞÜ

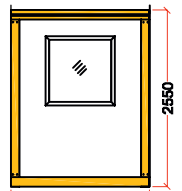

SAĞ CEPHE GÖRÜNÜŞÜ

## WC DUŞ KONTEYNER

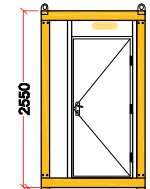

ÖN CEPHE GÖRÜNÜŞÜ

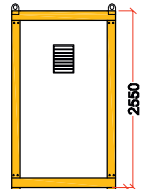

ARKA CEPHE GÖRÜNÜŞÜ

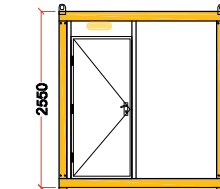

ÖN CEPHE GÖRÜNÜŞÜ

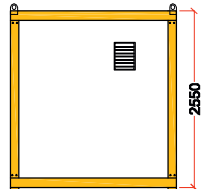

ARKA CEPHE GÖRÜNÜŞÜ

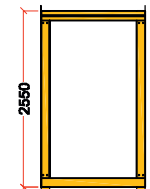
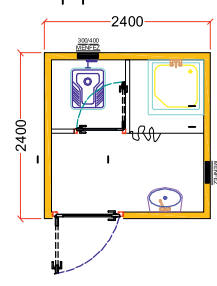
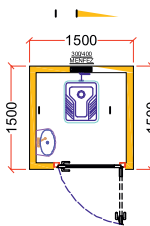

SOL CEPHE GÖRÜNÜŞÜ

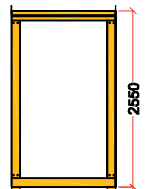

SAĞ CEPHE GÖRÜNÜŞÜ

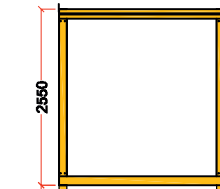

SOL CEPHE GÖRÜNÜŞÜ

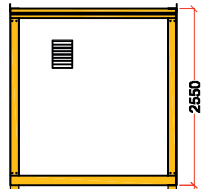

SAĞ CEPHE GÖRÜNÜŞÜ



## KONUT TİPİ KONTEYNER

28 m<sup>2</sup>

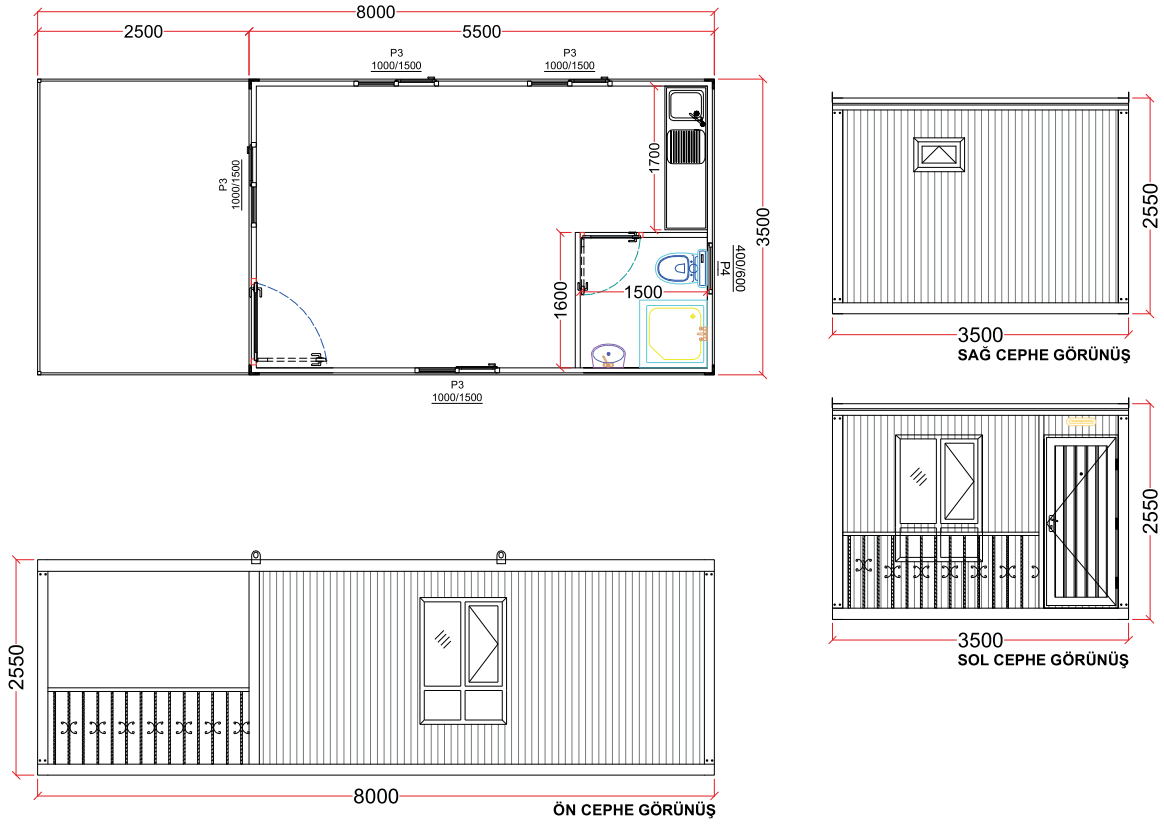

## KONUT TİPİ KONTEYNER

42 m<sup>2</sup>

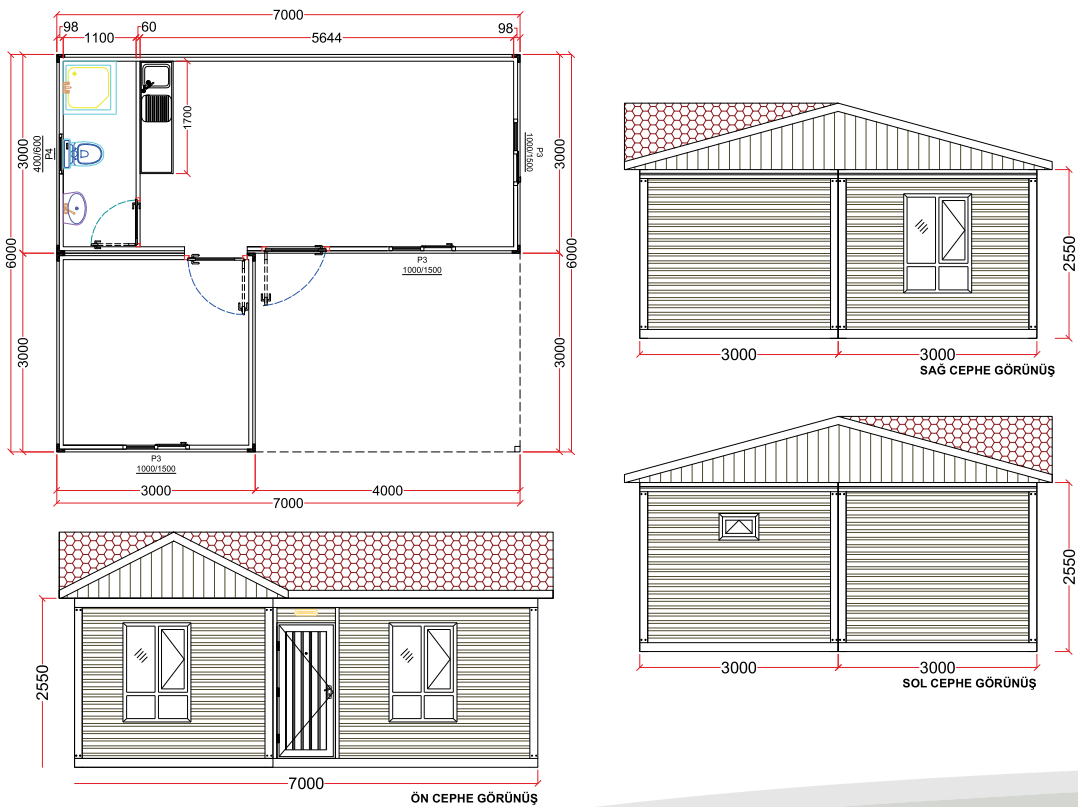

## KONUT TİPİ KONTEYNER

56 m<sup>2</sup>

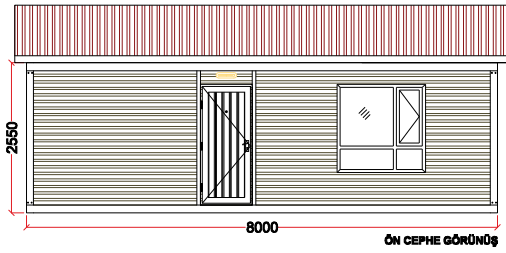
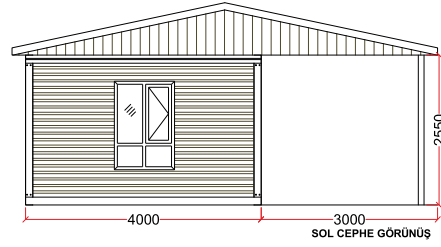
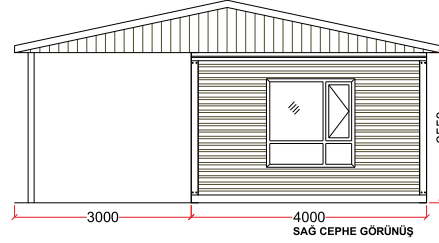
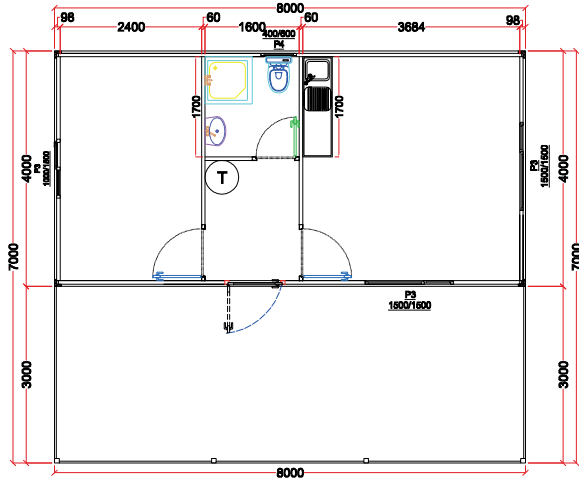

## KONUT TİPİ KONTEYNER

63 m<sup>2</sup>

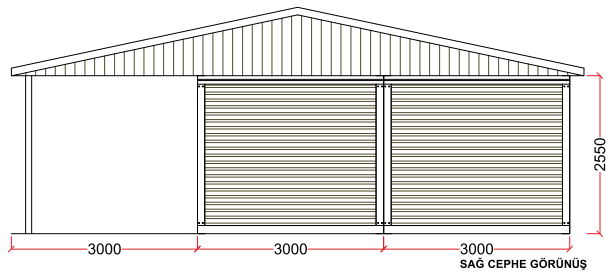
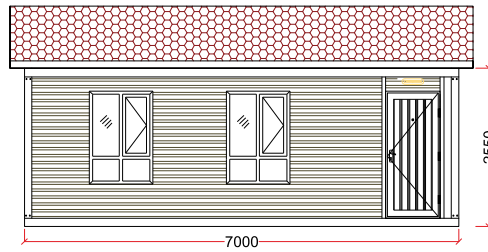
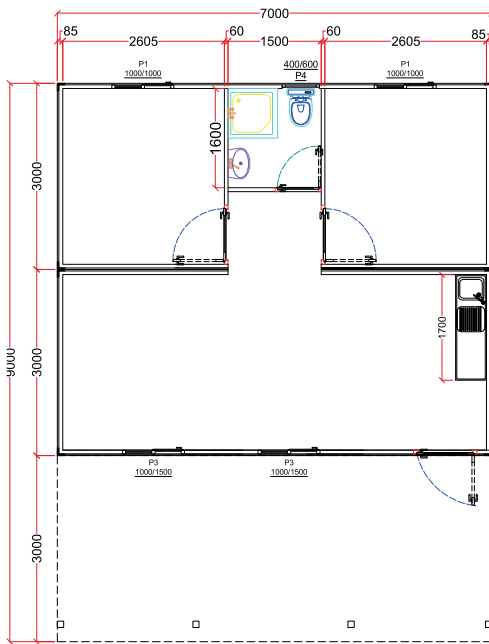

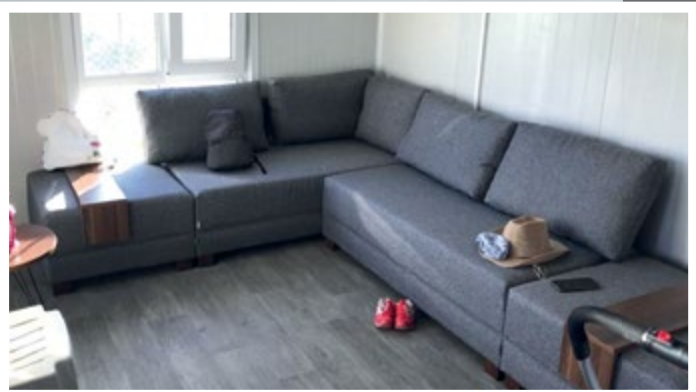





## 1+1 PREFABRİK KONUT

45.46 m<sup>2</sup>

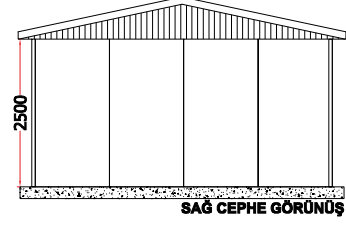
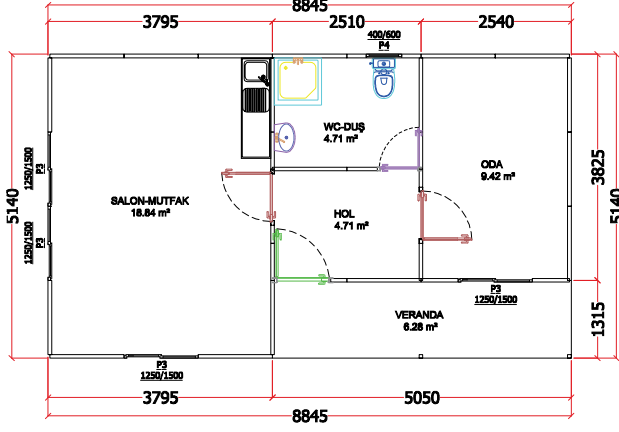

SAĞ CEPHE GÖRÜNÜŞ

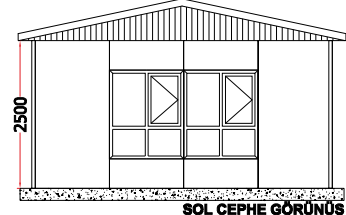

SOL CEPHE GÖRÜNÜŞ

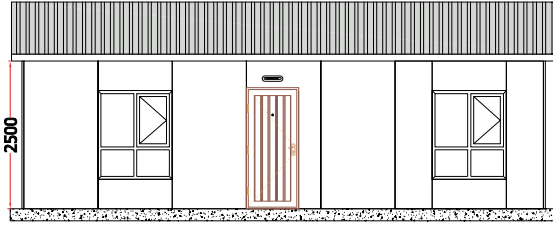

ÖN CEPHE GÖRÜNÜŞ

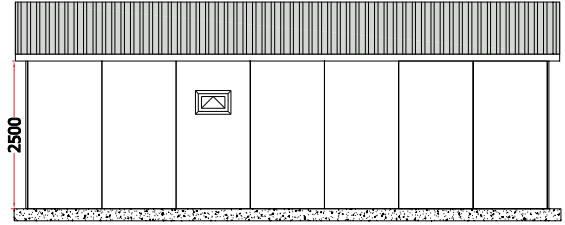

ARKA CEPHE GÖRÜNÜŞ

## 1+1 PREFABRİK KONUT

48.54 m<sup>2</sup>

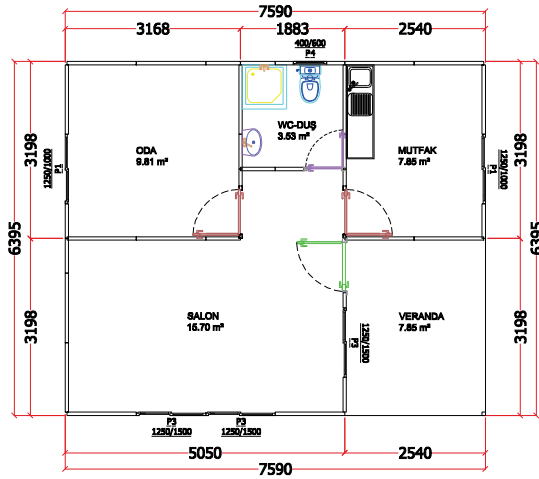

SAĞ CEPHE GÖRÜNÜŞ

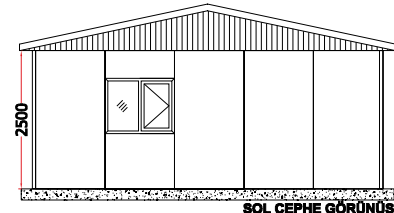

SOL CEPHE GÖRÜNÜŞ

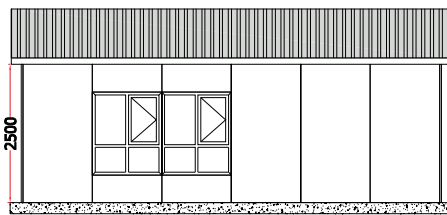

ÖN CEPHE GÖRÜNÜŞ

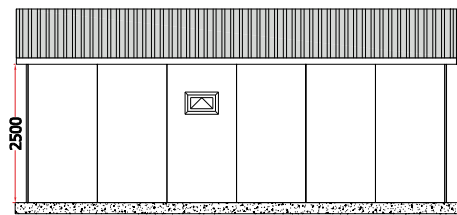

ARKA CEPHE GÖRÜNÜŞ

## 2+1 PREFABRİK KONUT

67.66 m<sup>2</sup>

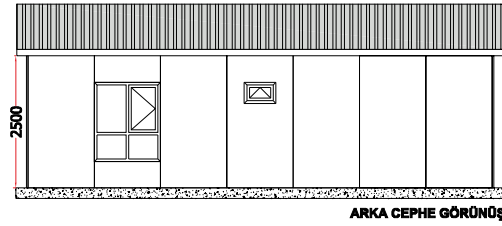
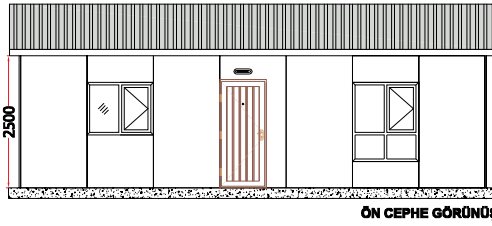
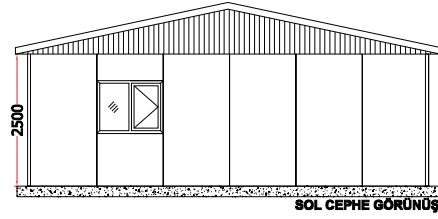
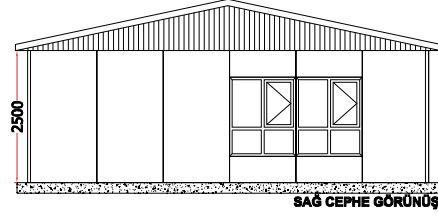
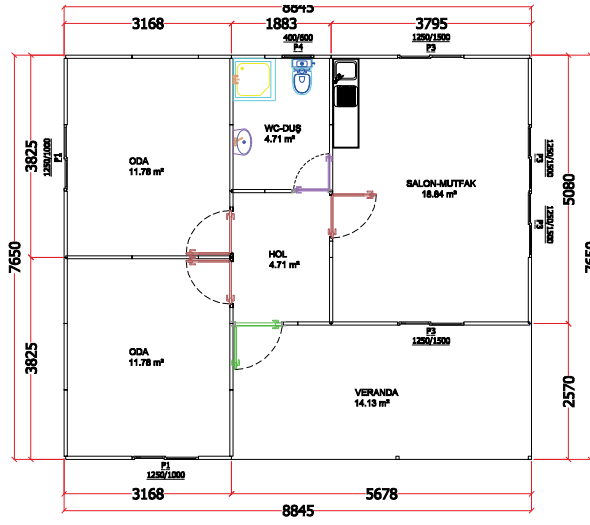

## 2+1 PREFABRİK KONUT

78.76 m<sup>2</sup>

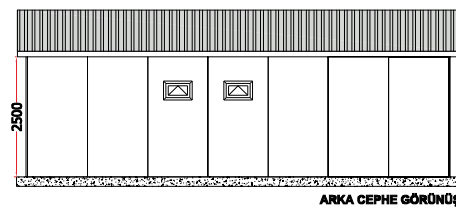
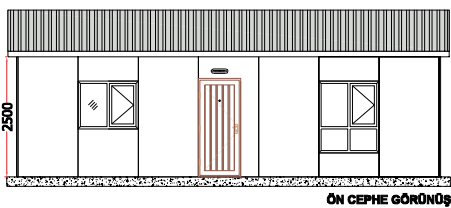
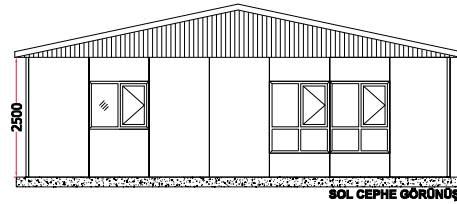
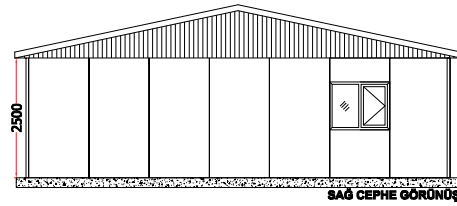
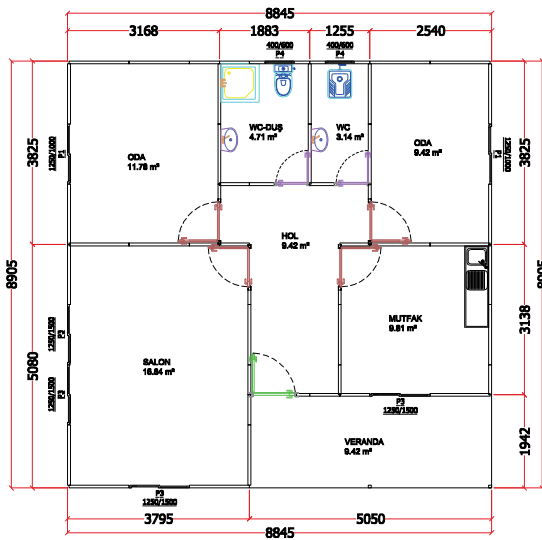

## 3+1 PREFABRİK KONUT

86.87 m<sup>2</sup>

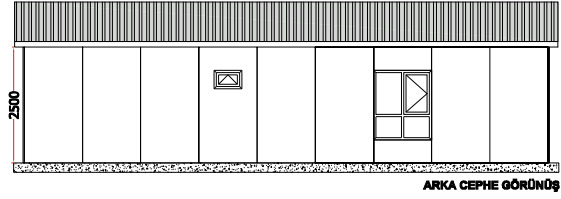
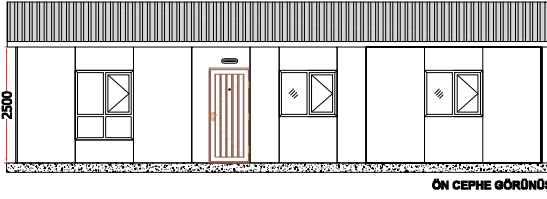
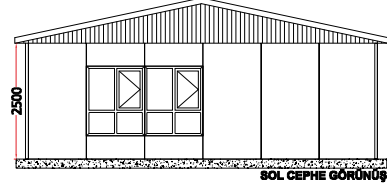
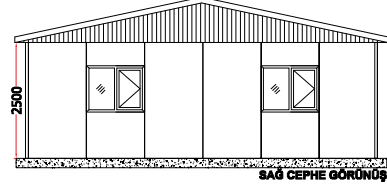
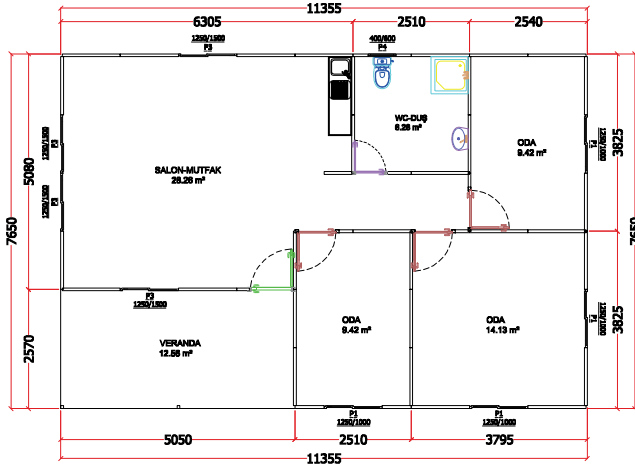

## 3+1 PREFABRİK KONUT

102.62 m<sup>2</sup>

